

Assembly manual

Blue Spot (7091.95)

Introduction

Foreword

The installation procedures described in this assembly manual may only be undertaken by a Hako service centre or a workshop authorised by Hako. Members of staff with the required level of training and expertise are only guaranteed in the said workshops.

This assembly manual may be used only in conjunction with the instruction manual of the machine.

Safety instructions

Please observe the general safety regulations of the corresponding machine in the relevant operating manual. Place the machine on a level surface and secure it with the parking brake. Switch the machine off and pull out the key.

We would expressly advise you that no legal claims may be asserted based on the contents of this manual. In the case of necessary repair work, please make sure that only original spare parts are used. Only original spare parts guarantee constant and reliable operational readiness of your machine. We reserve the right to make changes in the interests of further technical development.

Valid as from: June 2019

Hako GmbH
23843 Bad Oldesloe, Germany
Hamburger Str. 209-239
Phone +49 4531 806-0

1 Blue Spot

1.1 Parts list

- 1x Blue Spot preassembled
- 3x EJOT-PT bolt
- 1x seal
- 1x signal transmitter 24 V
- 2x self-tapping screw 2,9x13
- 1x cable harness W69
- 3x cable tie

1.2 Installing the LED lamp

1. Remove the cover (Fig. 1/1) at the steering column (bolts are no longer required).
2. Insert the cable through the opening into the steering column.
3. Attach the Blue Spot with seal and EJOT bolts to the steering column (Fig. 1/2) with a tightening torque of 1.1 Nm.

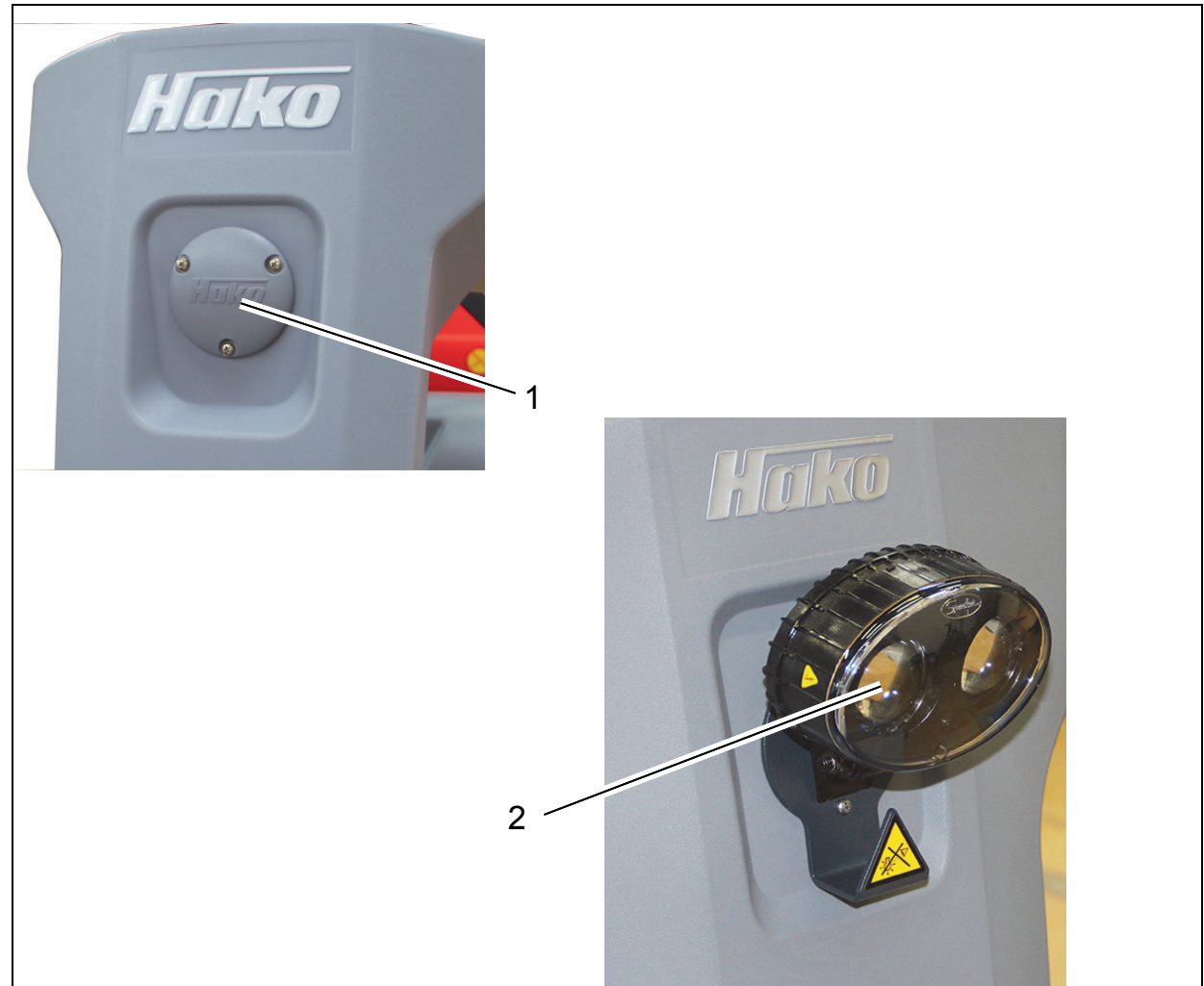

Fig.1

Blue Spot

1.3 Installing the signal transmitter

1. Dismount steering wheel and control panel.
2. Fix the signal transmitter (Fig. 2/1) to the inside of the steering column with the two self-tapping screws.

1.4 Connections

Place the cable harness W69 (Fig. 2/2) in the steering tower as shown.

Connect the cable harness W69 to...

- signal transmitter P03 (Fig. 2/3)
- cable harness W3 X24 (Fig. 2/4)

Connect Blue Spot cable to connector X25 of harness W3 (Fig. 2/5).

Secure cable harnesses as shown with cable ties (Fig. 2/6).

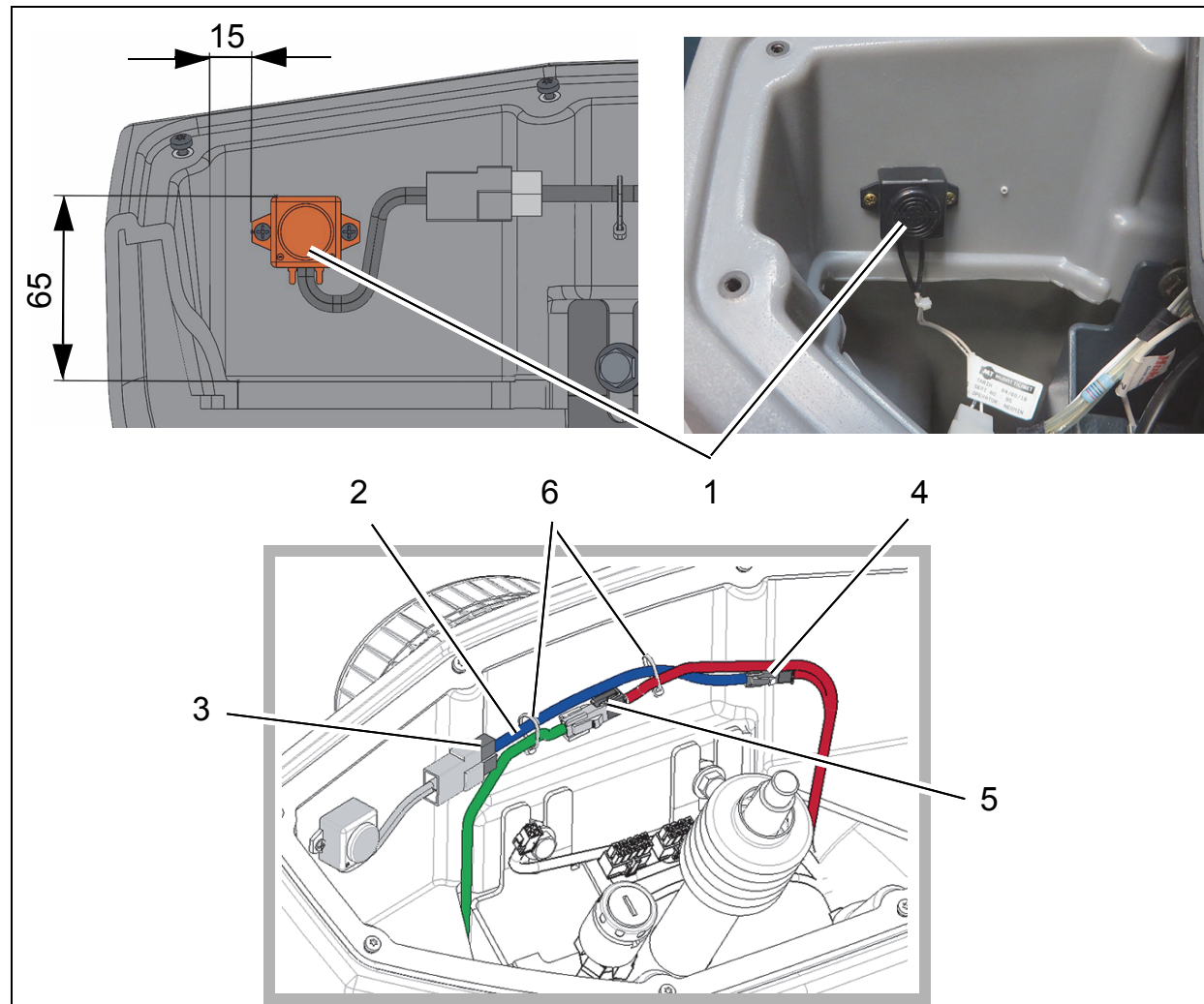

Fig.2

1.5 Setting in the configuration menu

The Blue Spot option must be activated via the configuration menu.

Option	Value
Blue Spot	1. C. 1.

Requirements:

- Batteries inserted
- 4-digit code or diagnosis plug 97097737 is present.

If diagnosis plug is used:

Connect diagnosis plug to slot X20 of controller A1 (Fig. 3/1).

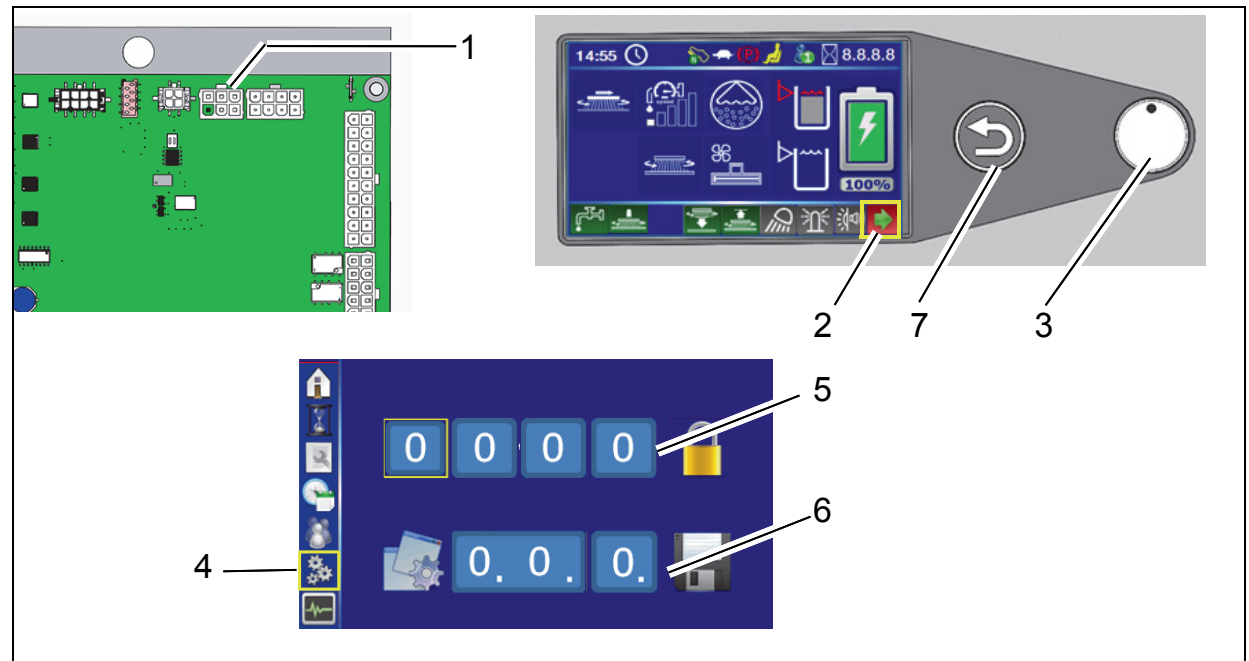

Fig. 3

Setting:

1. Turn on the machine.
2. Select the arrow softkey (Fig. 3/3) on the control panel using the turn-push knob (DDS) (Fig. 3/2) and press to access the sub-menu.
3. Select the configuration menu in the sub-menu (Fig. 3/4).

4. Enter the 4-digit code in the configuration menu at the top (Fig. 3/5):
 - Rotate the DDS until the required field is reached.
 - Press DDS, then rotate to adjust the value.
 - Press again to save the value.
 Alternatively, use the diagnosis plug!

5. Select the value of the option under (Fig. 3/6) in the configuration menu and save by pressing the DDS. After confirmation of the final digit, *OK?* appears. Press the DDS again to save the value. The saved value is now displayed in green. If the value is not to be saved, exit the menu using the return button (Fig. 3/7).



Advanced Technology for a Cleaner, Better Environment

88-10-3176 - 4070-36



Hako GmbH • Head Office • Hamburger Str. 209-239 • 23843 Bad Oldesloe • Germany
Phone +49 4531 806-0 • Fax +49 4531 806-338